

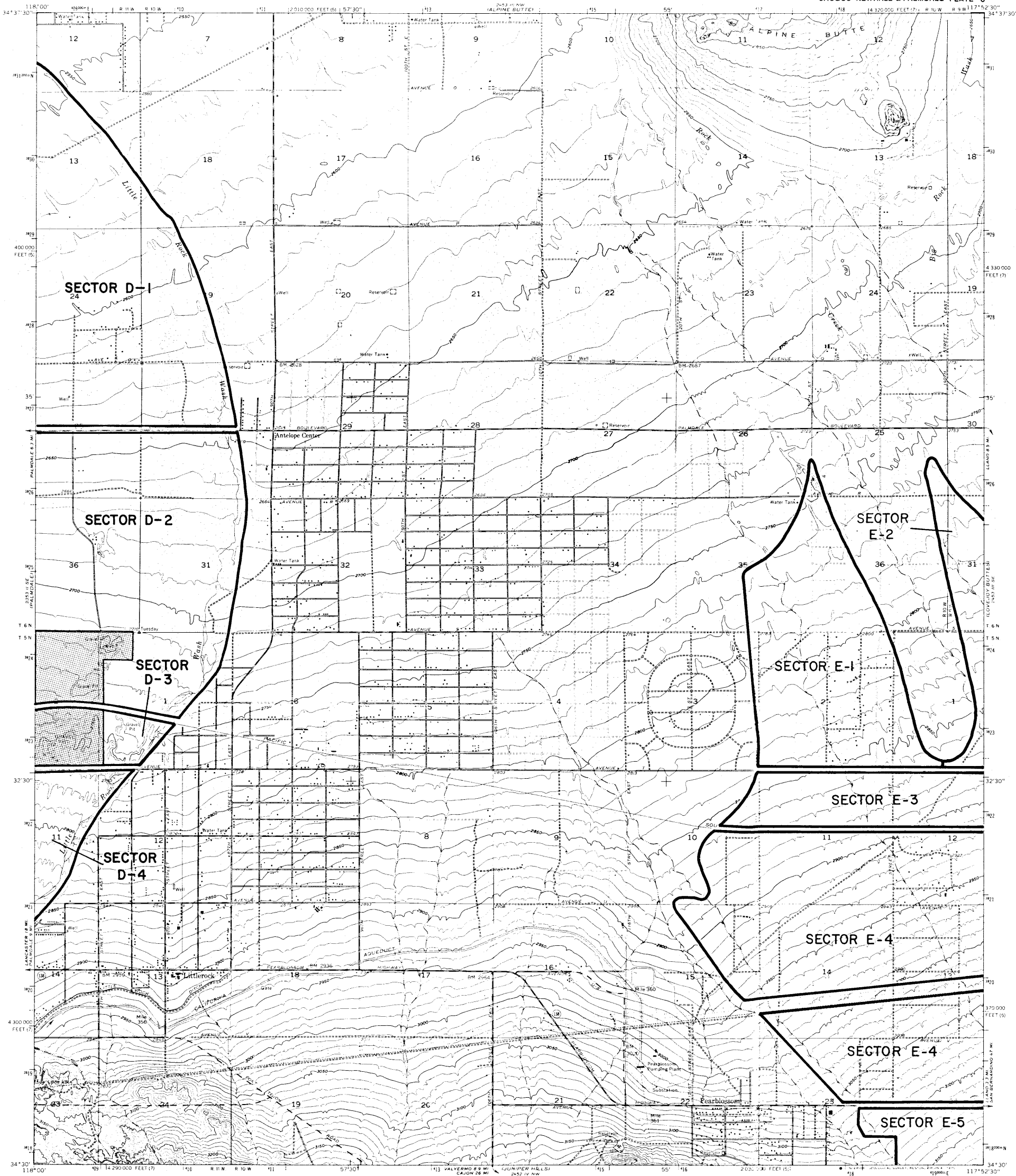

STATE MINING AND GEOLOGY BOARD  
JAMES A. ANDERSON, CHAIRMAN

STATE OF CALIFORNIA—GEORGE DEUKMEJIAN, GOVERNOR  
THE RESOURCES AGENCY—GORDON K. VAN VLECK, SECRETARY FOR RESOURCES  
DEPARTMENT OF CONSERVATION—RANDALL M. WARD, DIRECTOR

LITTLEROCK QUADRANGLE  
SMARA DESIGNATION MAP NO. 85-3  
SAUGUS-NEWHALL & PALMDALE PLATE 6



TOPOGRAPHIC BASE MAP BY U.S. GEOLOGICAL SURVEY  
REDUCED FROM 1:24,000



CONTOUR INTERVAL 10 FEET  
NATIONAL GEODETIC VERT. CAL. DATUM OF 1929

LITTLEROCK, CALIF.

EXPLANATION

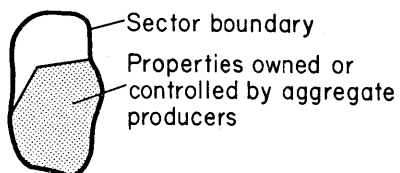

Regionally Significant Construction  
Aggregate Resource Areas In The  
**SAUGUS-NEWHALL & PALMDALE**  
Production-Consumption Region

STATE MINING AND GEOLOGY BOARD  
JANUARY 1987

PREPARED IN COMPLIANCE WITH THE SURFACE MINING  
AND RECLAMATION ACT OF 1975, ARTICLE 4, SECTION 2790