

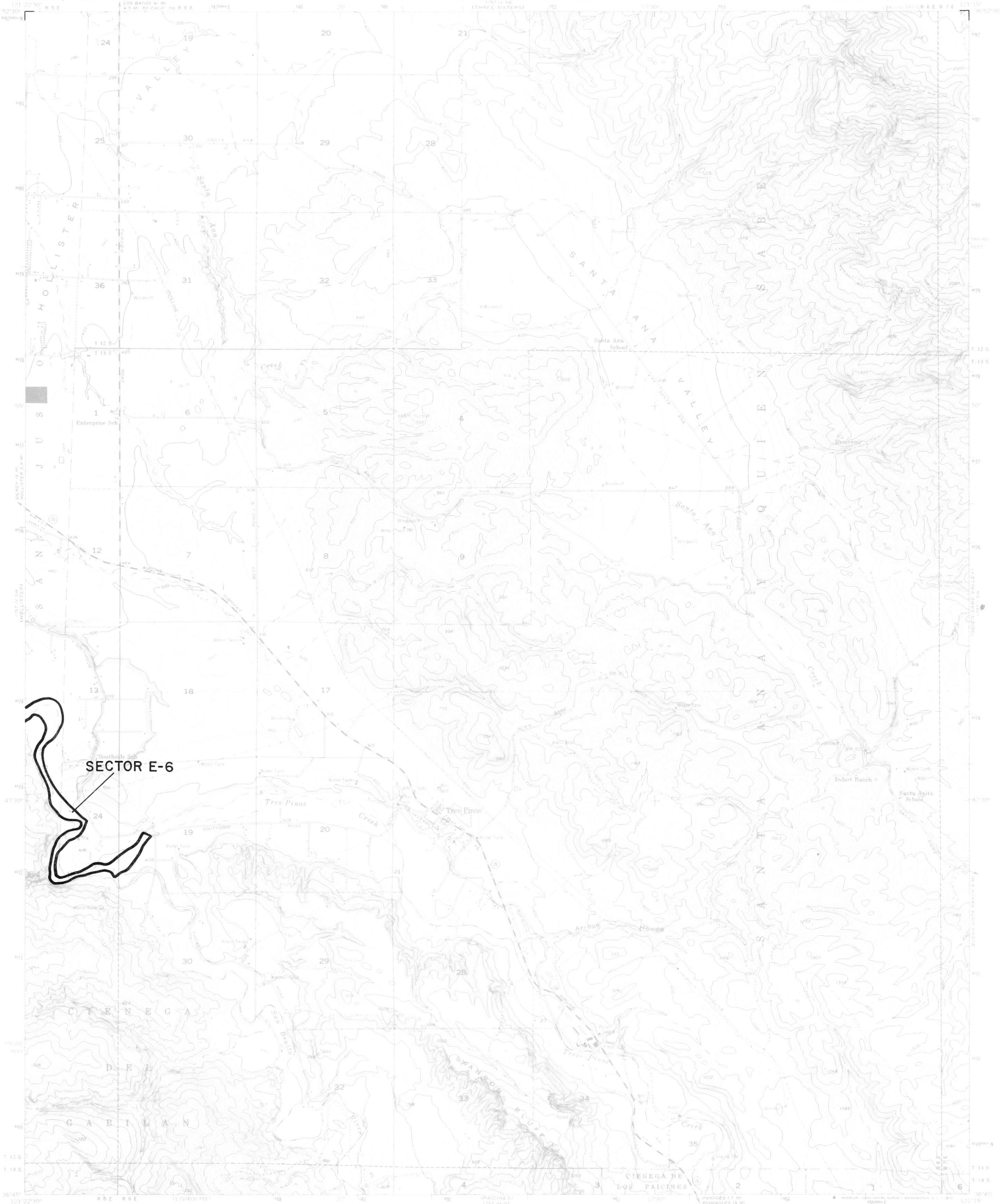

STATE OF CALIFORNIA—GEORGE DEUKMEJIAN, GOVERNOR
 THE RESOURCES AGENCY—GORDON K. VAN VLECK, SECRETARY FOR RESOURCES
 DEPARTMENT OF CONSERVATION—RANDALL M. WARD, DIRECTOR

TRES PINOS QUADRANGLE
 SMARA DESIGNATION MAP NO. 85-6
 MONTEREY BAY PLATE 7

DIVISION OF MINES AND GEOLOGY
 JAMES F. DAVIS, STATE GEOLOGIST



TOPOGRAPHIC BASE MAP BY U.S. GEOLOGICAL SURVEY
 Reduced from 1:24,000



CONTOUR INTERVAL: 20 FEET
 DASHED LINES REPRESENT HALF INTERVAL CONTOURS
 (LADIM IS MEAN SEA LEVEL)

TRES PINOS, CALIF.

EXPLANATION

- Sector boundary
- Properties owned or controlled by aggregate producers
- Depleted resources



Regionally Significant Construction
 Aggregate Resource Areas In The
MONTEREY BAY
 Production-Consumption Region

STATE MINING AND GEOLOGY BOARD
 JANUARY 1987

PREPARED IN COMPLIANCE WITH THE SURFACE MINING
 AND RECLAMATION ACT OF 1975, ARTICLE 4, SECTION 2790