

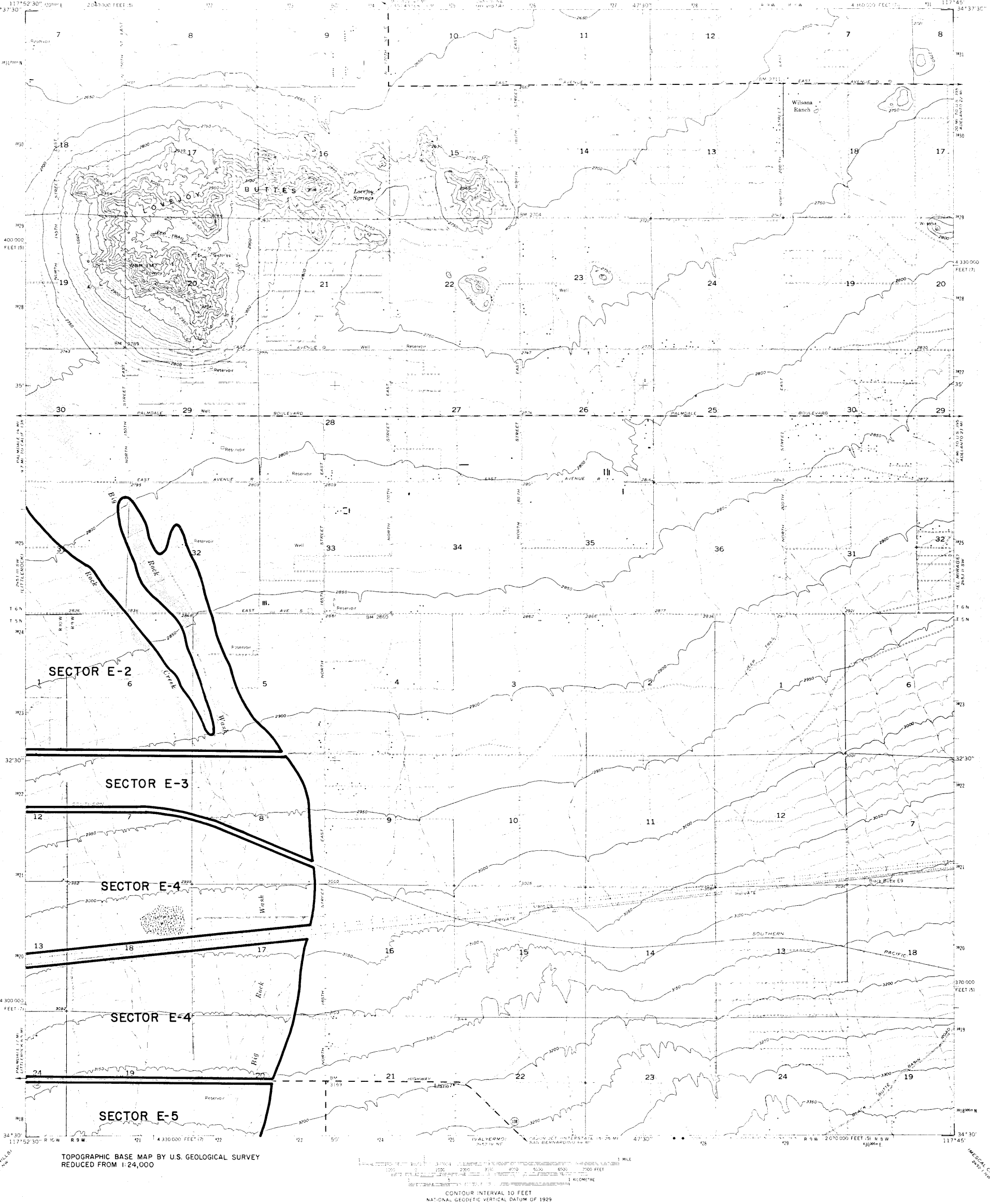

STATE MINING AND GEOLOGY BOARD
JAMES A. ANDERSON, CHAIRMAN

STATE OF CALIFORNIA—GEORGE DEUKMEJIAN, GOVERNOR
THE RESOURCES AGENCY—GORDON K. VAN VLECK, SECRETARY FOR RESOURCES
DEPARTMENT OF CONSERVATION—RANDALL M. WARD, DIRECTOR

LOVEJOY BUTTES QUADRANGLE
SMARA DESIGNATION MAP NO. 85-3
SAUGUS-NEWHALL & PALMDALE PLATE 7



EXPLANATION

-  Sector boundary
-  Properties owned or controlled by aggregate producers



**Regionally Significant Construction
Aggregate Resource Areas In The
SAUGUS-NEWHALL & PALMDALE
Production-Consumption Region**

STATE MINING AND GEOLOGY BOARD
SEPTEMBER 1985

PREPARED IN COMPLIANCE WITH THE SURFACE MINING
AND RECLAMATION ACT OF 1975, ARTICLE 4, SECTION 2790

LOVEJOY BUTTES, CALIF.