

UNITED STATES  
DEPARTMENT OF THE INTERIOR  
GEOLOGICAL SURVEY

STATE OF CALIFORNIA  
THE RESOURCES AGENCY  
DEPARTMENT OF FORESTRY - Division V  
REGION 1 GEOLOGY GROUP  
17300 153

GEOLOGIC MAP  
FRANKLIN POINT  
QUADRANGLE  
Compiled by J.S. Bullock Date 11/75  
Approved M.E. Hoffmann CDMG

FRANKLIN POINT QUADRANGLE  
CALIFORNIA  
7.5 MINUTE SERIES (TOPOGRAPHIC)  
NE/4 AÑO NUEVO 15' QUADRANGLE

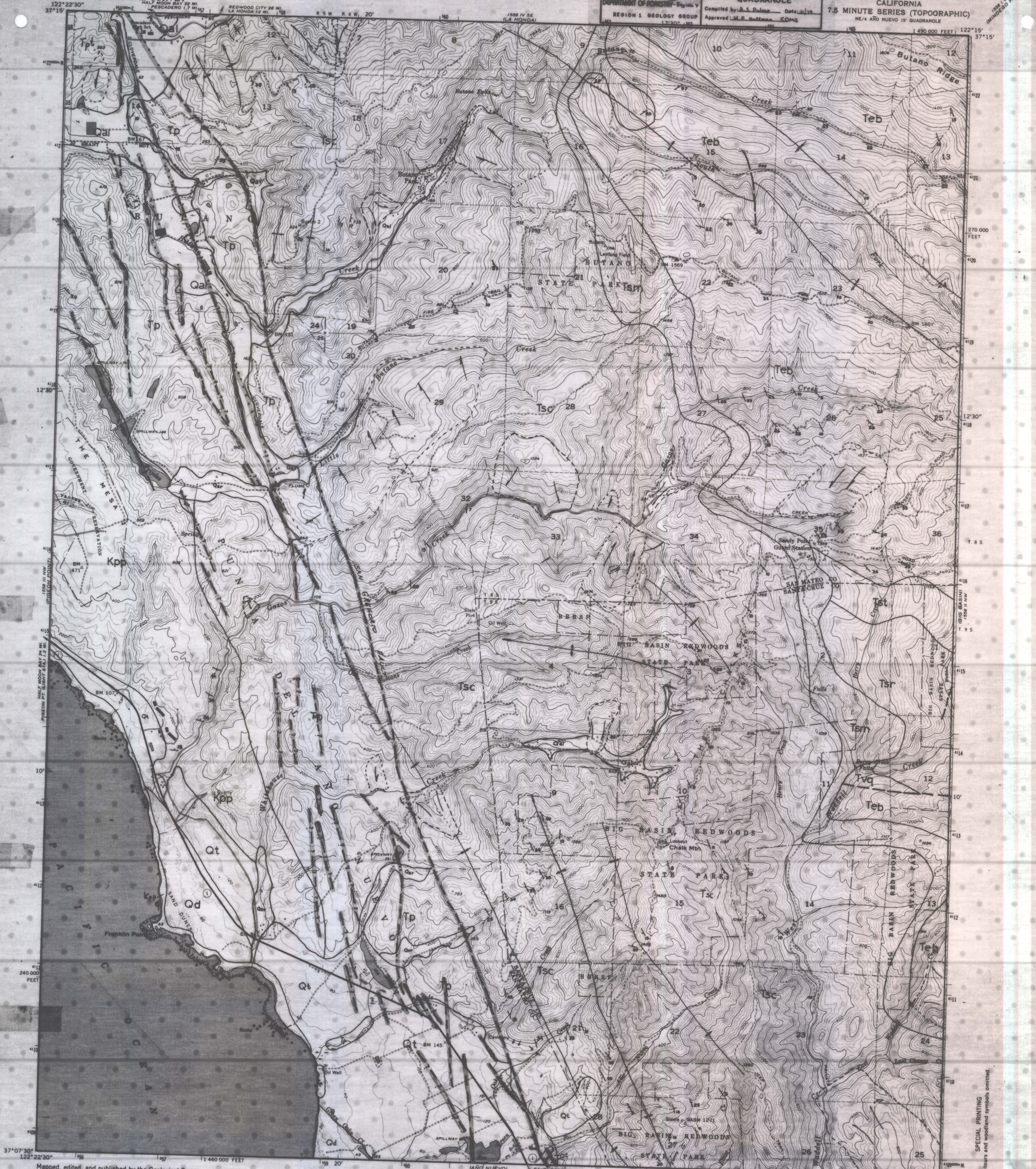

Mapped, edited, and published by the Geological Survey  
Control by USGS, USC&GS, and USCE  
Topography from aerial photographs by multiplex methods  
Aerial photographs taken 1953. Field check 1955  
Polyconic projection. 1927 North American datum  
10,000-foot grid based on California coordinate system, zone 3  
1000-meter Universal Transverse Mercator grid ticks,  
zone 10, shown in blue  
Where omitted, land lines have not been established  
Dotted land lines were established by private survey  
Revisions shown in purple compiled from aerial photographs  
taken 1968. This information not field checked

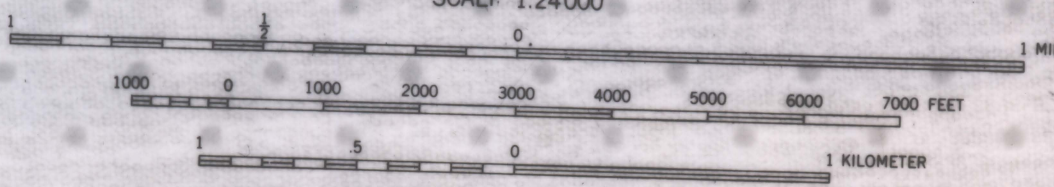
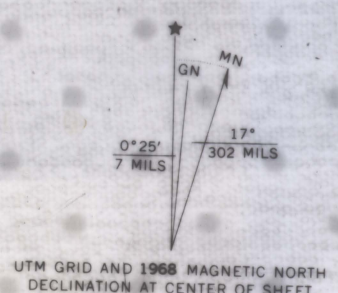

CONTOUR INTERVAL 40 FEET  
DASHED LINES REPRESENT 20-FOOT CONTOURS  
DATUM IS MEAN SEA LEVEL  
SHORELINE SHOWN REPRESENTS THE APPROXIMATE LINE OF MEAN HIGH WATER  
THE AVERAGE RANGE OF TIDE IS APPROXIMATELY 4 FEET

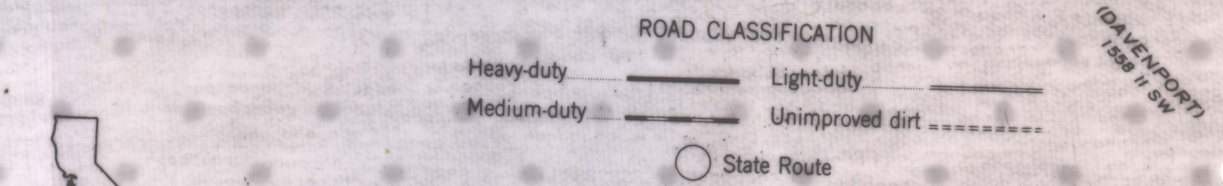

FRANKLIN POINT, CALIF.  
NE/4 AÑO NUEVO 15' QUADRANGLE  
N3707.5 - W12215.7.5

THIS MAP COMPLIES WITH NATIONAL MAP ACCURACY STANDARDS  
FOR SALE BY U.S. GEOLOGICAL SURVEY, DENVER, COLORADO 80225, OR WASHINGTON, D.C. 20242  
A FOLDER DESCRIBING TOPOGRAPHIC MAPS AND SYMBOLS IS AVAILABLE ON REQUEST

1955  
PHOTOREVISED 1968  
AMS 1558 III NE-SERIES V895

SPECIAL PRINTING  
Contours and woodland symbols omitted