

Example Map for Notice of Intention

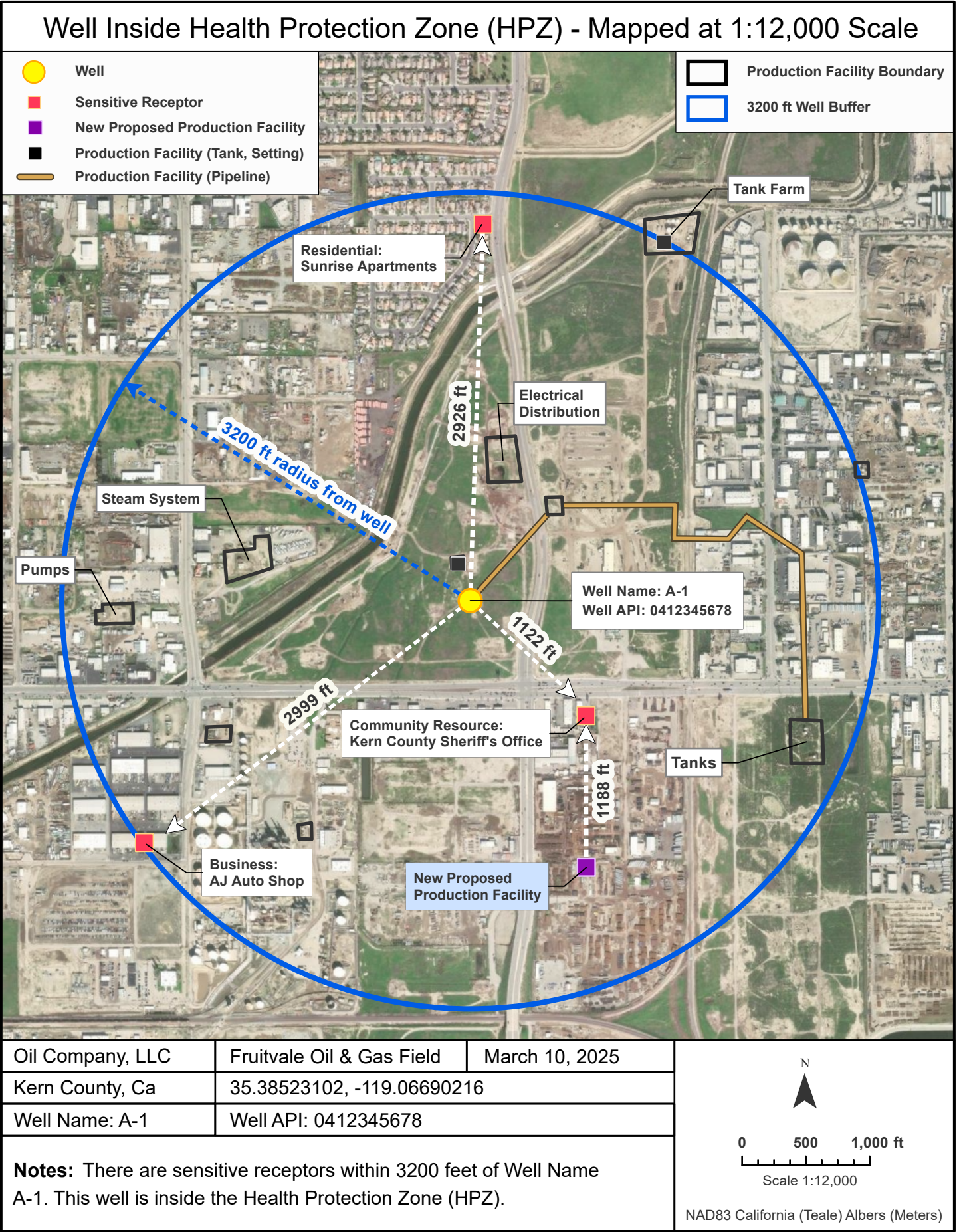

Oil Company, LLC	Fruitvale Oil & Gas Field	March 10, 2025
Kern County, Ca	35.38523102, -119.06690216	
Well Name: A-1	Well API: 0412345678	

Notes: There are sensitive receptors within 3200 feet of Well Name A-1. This well is inside the Health Protection Zone (HPZ).

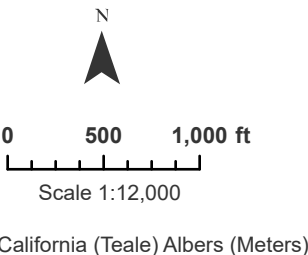

Example Map for Notice of Intention

Well Inside Health Protection Zone (HPZ) - Mapped at 1:12,000 Scale

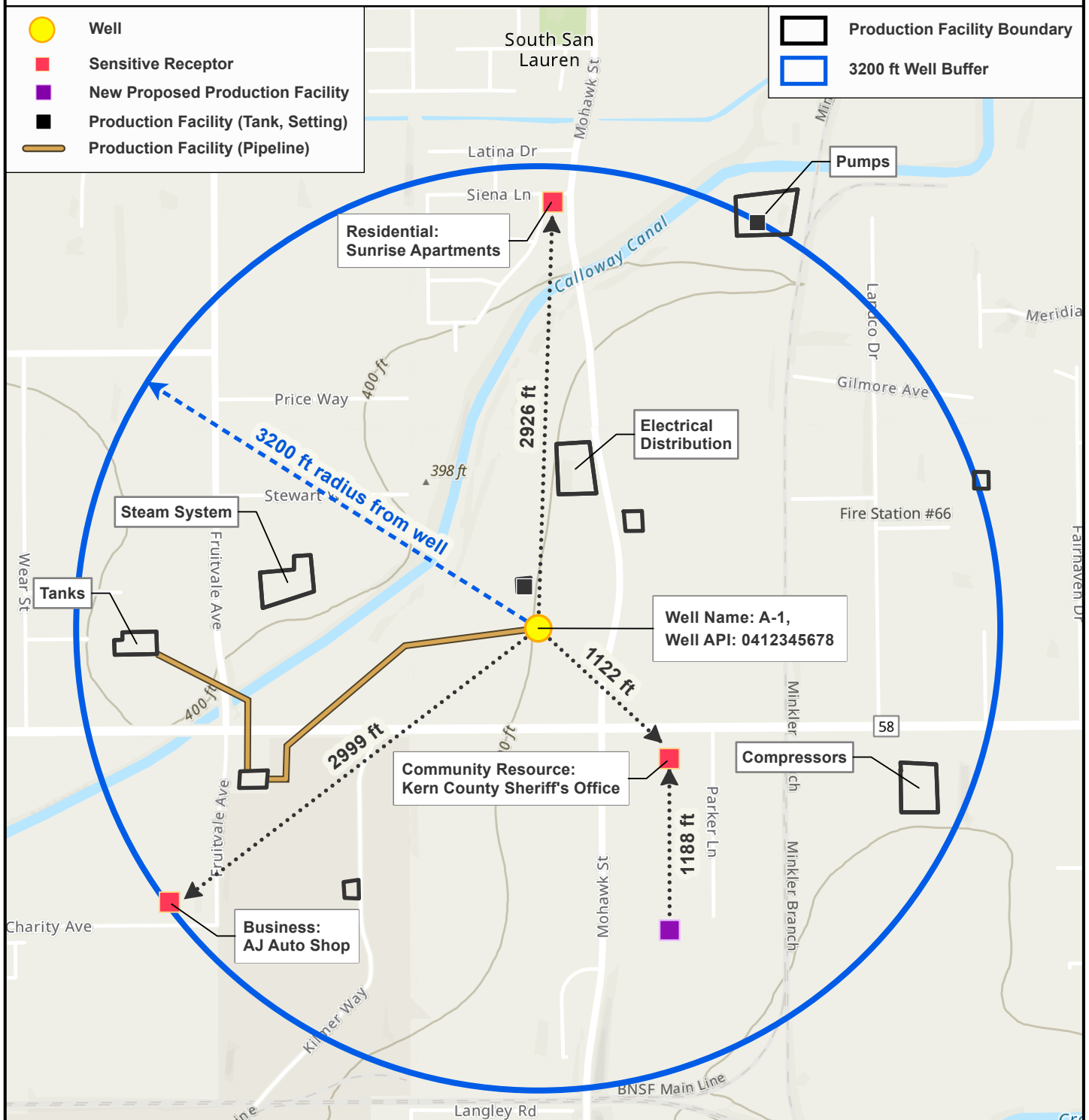

Oil Company, LLC	Fruitvale Oil & Gas Field	March 10, 2025
Kern, Ca	35.38523102, -119.06690216	
Well Name: A-1	Well API: 0412345678	

Notes: There are sensitive receptors within 3200 feet of Well Name A-1. This well is inside a Health Protection Zone (HPZ).

